

# SHIMANO 105 Cassette Sprocket

## CS-R7000 11-speed

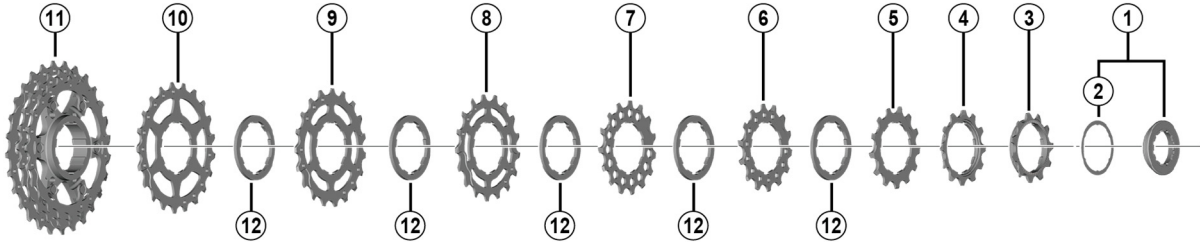

### CS-R7000 sprocket teeth combinations

11 - 28 T	11 - 12 - 13 - 14 - 15 - 17 - 19 - 21 - <u>23 - 25 - 28</u> T
11 - 30 T	11 - 12 - 13 - 14 - 15 - 17 - 19 - 21 - <u>24 - 27 - 30</u> T
11 - 32 T	11 - 12 - 13 - 14 - 16 - 18 - 20 - 22 - <u>25 - 28 - 32</u> T
12 - 25 T	12 - 13 - 14 - 15 - 16 - 17 - 18 - 19 - <u>21 - 23 - 25</u> T

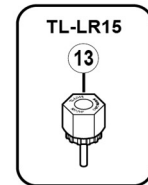

ITEM NO.	SHIMANO CODE NO.	DESCRIPTION	INTERCHANGEABILITY		
			CS-R8000	CS-8800	CS-5800
1	Y1WW98010	Lock Ring & Spacer			A
2	Y10Z04000	Lock Ring Spacer			A
3	Y1PJ11000	Sprocket Wheel 11T A (Built in spacer type) for 11-28T, 11-30T, 11-32T	B	B	A
	Y1PJ12100	Sprocket Wheel 12T B (Built in spacer type) for 12-25T	B	B	A
4	Y1PJ12200	Sprocket Wheel 12T A (Built in spacer type) for 11-28T, 11-30T, 11-32T	B	B	A
	Y1PJ13100	Sprocket Wheel 13T B (Built in spacer type) for 12-25T	B	B	A
5	Y1PJ13200	Sprocket Wheel 13T A for 11-28T, 11-30T, 11-32T	B	B	A
	Y1PJ14000	Sprocket Wheel 14T A for 12-25T	B	B	A
6	Y1PJ14000	Sprocket Wheel 14T A for 11-28T, 11-30T, 11-32T	B	B	A
	Y1PJ15000	Sprocket Wheel 15T A for 12-25T	B	B	A
7	Y1PJ15000	Sprocket Wheel 15T A for 11-28T, 11-30T	B	B	A
	Y1PJ16100	Sprocket Wheel 16T B for 11-32T	B	B	A
8	Y1PJ16000	Sprocket Wheel 16T A for 12-25T	B	B	A
	Y1PJ17100	Sprocket Wheel 17T B for 11-28T, 11-30T	B	B	A
9	Y1PJ18200	Sprocket Wheel 18T C for 11-32T	B	B	A
	Y1PJ17200	Sprocket Wheel 17T C for 12-25T	B	B	A
10	Y1PJ19400	Sprocket Wheel 19T E for 11-28T, 11-30T			A
	Y1PJ20100	Sprocket Wheel 20T B for 11-32T			A
11	Y1PJ18300	Sprocket Wheel 18T D for 12-25T			A
	Y1PJ21300	Sprocket Wheel 21T D for 11-28T, 11-30T			A
12	Y1PJ22100	Sprocket Wheel 22T B for 11-32T			A
	Y1PJ19500	Sprocket Wheel 19T F for 12-25T			A
13	Y1WW98020	Sprocket Unit (23-25-28T) for 11-28T	B	B	A
	Y1WW98030	Sprocket Unit (24-27-30T) for 11-30T	B	B	A
14	Y1WW98040	Sprocket Unit (25-28-32T) for 11-32T	B	B	A
	Y1WW98050	Sprocket Unit (21-23-25T) for 12-25T	B	B	A
15	Y1PJ03000	Sprocket Spacer (t=2.18 mm)	B	B	A
16	Y12009230	Lock Ring Removal Tool (TL-LR15)	A	A	A

A: Same parts.

B: Parts are usable, but differ in materials, appearance, finish, size, etc.

Absence of mark indicates non-interchangeability.

Specifications are subject to change without notice.

Apr.-2018-4330

© Shimano Inc. I

# SHIMANO